

APPLICATION SHEET

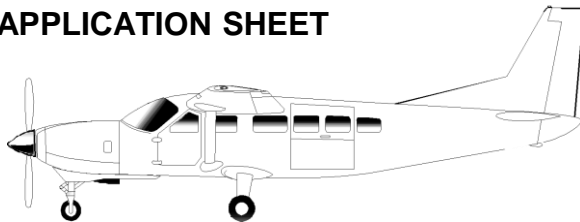

BARRY CONTROLS™



**FAA REPAIR STATION UT3R905L
JAA JAR 145.10
FAA-PMA PARTS MANUFACTURING APPROVED**

**ENGINE VIBRATION ISOLATORS
TYPE MB4040, MB100875, and MB100876**

Barry Controls™ Aerospace designs and manufactures engine vibration isolation systems to meet the exacting standards of the aircraft industry. These systems are designed to reduce the magnitude of vibration transmitted from the propeller/powerplant to the airframe. Isolation provides: reduced pilot fatigue, passenger comfort, and maximum protection of the aircraft structure and systems from damaging vibration. To assure maximum protection and performance from the isolation system, replacement is recommended at each engine overhaul.

Barry Controls™ Aerospace has been granted Parts Manufacturer Approval (PMA) for engine vibration isolators type numbers MB4040, MB100875, and MB100876 used in the aircraft listed below. One complete engine vibration isolation system consists of six isolators paired together by three torque arms. Each isolator consists of two vulcanize-bonded core assemblies, housing, stud, and associated components as shown on sheet 2. All primary and secondary components of the isolator are steel and are cadmium plated or passivated for maximum corrosion resistance and durability.

APPLICATIONS

AIRCRAFT MANUFACTURER	AIRCRAFT MODEL	ENGINE	PART NUMBER	ISOLATORS PER ENG	ISOLATORS PER AC
de Havilland	DHC-2 Beaver	R-985	MB100875	6	6
	DHC-3 Otter	R-1340	MB4040	6	6
Gulfstream American	G-164A Ag Cat	R-985	MB100875	6	12
		R-1340	MB100876	6	12
	G-164B Ag Cat	R-985	MB100875	6	12

Barry Controls™ Aerospace vibration isolators are sold as assemblies. The illustrated parts breakdown and part number list is provided as reference only. For additional information, applications assistance, and technical support, please contact our customer service department.

APPLICATION SHEET

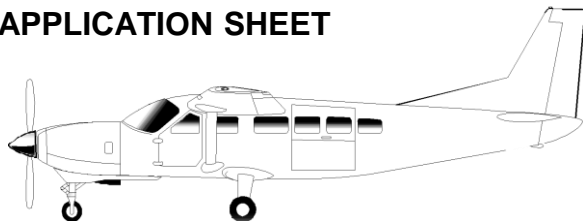

BARRY CONTROLS™



FAA REPAIR STATION UT3R905L

JAA JAR 145.10

FAA-PMA PARTS MANUFACTURING APPROVED

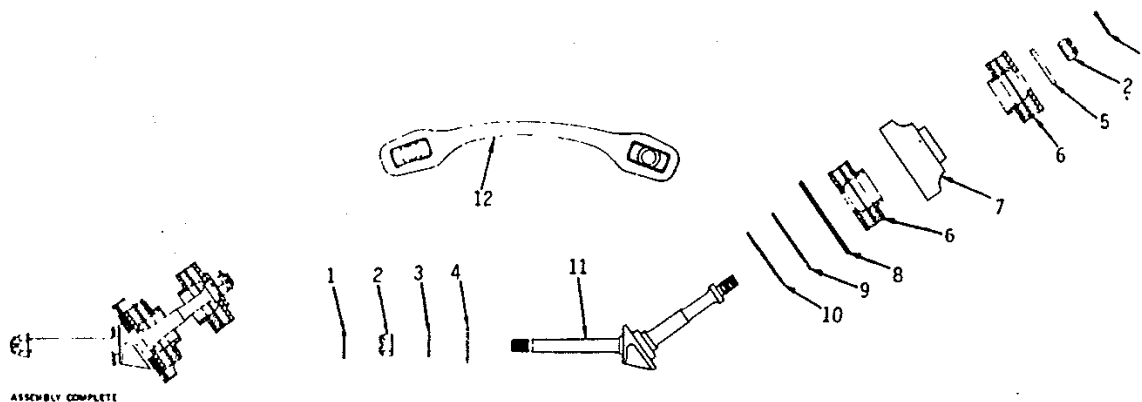

ITEM NO.	PART DESCRIPTION	PART NUMBER			QTY
-	ISOLATOR ASSEMBLY	MB4040	MB100875	MB100876	-
1	COTTER PIN		MB11359		2
2	NUT		MB35200		2
3	WASHER		MB41572		1
4	WASHER		MB108794		1
5	WASHER		MB100881		1
6	CORE ASSEMBLY*	MB4039	MB100878	MB100879	2
7	HOUSING		MB100880		1
8	DISC ASSEMBLY		MB100892		1
9	WASHER		MB100891		1
10	SPRING		MB100890		1
11	STUD		MB100888		1
12	TORQUE ARM ASSY		MB100877		**

* Verify the correct core assembly part number for each isolator

** One torque arm assembly unit required for each pair of isolator assemblies.

To maintain maximum performance of the isolation system, **Barry Controls** suggests replacing the core assemblies at every engine overhaul and returning the vibration isolator to **Barry Controls** for complete refurbishment at every second engine overhaul.

Barry Controls has been designated as Repair Station UT3R905L by the Federal Aviation Administration for complete overhaul service on aircraft vibration isolation systems.